

Eilon RON 3025/3050/3000 Crane Scale

NEW!
Product



(SEE CHART ON BACK OF PAGE FOR PART #'S)

RON 3025, 3050 and 3000 series crane scales are designed to accurately and efficiently weigh materials during a variety of manufacturing processes. These models feature large, six-digit LCD displays that are easy to read at a safe distance from the load. Performance-driven features include pushbutton tare and peak hold for capturing maximum values. Ensuring safety, all models are proof tested to 200% and feature a safety factor of 5:1, as well as a two-level overload warning. They're powered by rechargeable batteries that conveniently operate for up to 25 continuous hours. In addition, automatic shut-off (after 1.5 hours) conserves power when the units are not in use. For inventory and data management, the RON 3025 and RON 3050 are also available with optional RS-232 serial output for streaming data to a data acquisition device or PC.

Adding to the capabilities of the RON 3025 and 3050, the RON 3000 comes standard with RS-232 serial communications, analog output, two user-adjustable setpoints, and user-adjustable units of measure. The RON 3000 is available with a single or double-sided display to ensure visibility from all angles, and can be connected to optional remote displays.

Applications

- Loading vehicles - avoid overload fines
- Checking transportation/carriage charges by weighing shipments prior to loading
- Checking incoming raw materials from suppliers

Standard Features

- Two level overload warning
- Auto shut-off after 1.5 hours
- Operator keypad: ON/OFF, TARE, ZERO, ENTER, ESC, and PEAK HOLD
- Rechargeable batteries, up to 25 hours continuous use
- User calibration
- Liquid Crystal Display (LCD)
- Low battery warning
- Low headroom

RON 3000 additional features

- Single or dual display
- Two user-adjustable setpoints
- User-adjustable auto shut-off (60-5900 seconds)
- User-selectable units of measure (metric tons, short tons, kilo-newtons and lb)
- 4-20 mA analog output
- User-selectable baud rate (1200-9600)
- RS-232 continuous output for communication with computers or data acquisition devices (includes mating connector only, cable not included)

Options/Accessories

- Low temperature -13°F (-25°C)
- High temperature 175°F (80°C)
- Additional remote display with cable or wireless connection: 1.6" (40mm) Liquid Crystal Display (LCD)

RON 3025 & RON 3050 additional options

- RS-232 continuous output, 9600 baud, eight data bits, one stop bit, no parity (includes mating connector, cable not included)
- User selectable baud rate (1200-9600)
- 4-20 mA analog output
- Two user-adjustable setpoints
- User-adjustable auto shut-off (60-5900 seconds)
- User-selectable units of measure (metric tons, short tons, kilo-newtons, and lb)
- Indicator w/back-lit display (RON 3050 only)
- Integrated swivel with S.K.F Glycodur thrust and radial bearings (RON 3050 only, available in all capacities except 500 lb and 1000 lb)

RON 3000 additional options

- Integrated swivel with S.K.F Glycodur thrust and radial bearings (available in all capacities except 500 lb and 1000 lb)
- 15' (4.5m) infrared remote control
- Indicator w/back-lit display
- Additional remote displays with cable or wireless connection: 4" (100mm) Light Emitting Diode (LED) indoor model
4" (100mm) Light Emitting Diode (LED) outdoor model

NOTE: All options/accessories must be installed at time of order.

SAFETY FACTOR:

5:1 for load cell. 5:1 for the lifting eye. Average straightening load of the hook is at least 4 times the capacity

PROOF LOAD:

Each system tested to 200% (certified)

ACCURACY:

± 0.1% of full range

ENCLOSURE:

Robust extruded aluminum housing. Iridized and polyurethane coated

INDICATOR DISPLAY:

See chart below for display sizes

RON 3025: Liquid Crystal Display (LCD) and annunciators: two level overload warning, max. value (peak hold), low battery, and tare state

RON 3050 & RON 3000 (single & dual display): Liquid Crystal Display (LCD) and annunciator: Units, two level overload warning, max value (peak hold), low battery, tare state, and programming instruction.

UNITS:

RON 3025 & RON 3050: lb (consult factory to order a scale configured/defaulted for other units of measurement)

RON 3000: User selectable (metric tons, short tons, kilo-newtons and lb)

LOAD CELL:

High strength, aerospace quality, alloy steel, polyurethane coated
Hook and lifting eye are Crosby-Laughlin or equivalent

POWER:

Rechargeable batteries provide power for up to 25 hours continuous use. All data settings are retained at power off

CALIBRATION:

Factory calibrated, fully traceable (certificated)

TEMPERATURE RANGE:

14°F to 140°F (-10°C to 60°C)

ENVIRONMENTAL:

Weatherproof, NEMA 4, IP65

INPUTS/OUTPUTS (RON 3000 ONLY):

Analog output: 4-20 mA

Serial output: RS-232 with selectable baud rate (1200-9600)

Control output: setpoints control for overload detection and for other applications

Charge: charging input including charge control light

APPROVALS:

CE marked

WARRANTY:

One year limited warranty

RON 3025

PART #	CAPACITY	A	B	C	D Ø	E	H
Four-digit, 1.0" (25mm) Indicator Display							
69658.....	500 lb x 0.2 lb.....	2.0"	1.5"	0.875"	0.5"	1.0"	10.0"
69660.....	2000 lb x 1.0 lb.....	1.5"	1.25"	0.75"	0.375"	0.875"	9.0"
69661.....	2500 lb x 1.0 lb.....	2.0"	1.5"	0.875"	0.5"	1.0"	10.0"
69662.....	3200 lb x 1.0 lb.....	2.0"	1.5"	0.875"	0.5"	1.0"	10.0"
69663.....	5000 lb x 2.0 lb.....	2.625"	2.0"	1.125"	0.75"	1.125"	11.5"
69664.....	6000 lb x 2.0 lb.....	2.625"	2.0"	1.125"	0.75"	1.125"	11.5"
69665.....	6400 lb x 2.0 lb.....	2.625"	2.0"	1.125"	0.75"	1.125"	11.5"
Six-digit, 0.75" (19mm) Indicator Display							
69659.....	1000 lb x 0.5 lb.....	2.0"	1.5"	0.875"	0.5"	1.0"	10.0"
69666.....	10,000 lb x 5.0 lb.....	3.5"	2.5"	1.5"	1.0"	1.4375"	13.0"
69667.....	20,000 lb x 10.0 lb.....	4.0"	3.125"	2.25"	1.25"	2.25"	19.0"

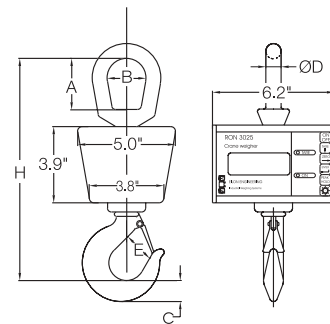

RON 3050

PART #	CAPACITY	A	B	C	D Ø	E	H
Four-digit, 2.0" (50mm) Indicator Display							
69668.....	500 lb x 0.2 lb.....	2.0"	1.5"	0.875"	0.5"	1.0"	10.0"
69670.....	2000 lb x 1.0 lb.....	1.5"	1.25"	0.75"	0.375"	0.875"	9.0"
69671.....	2500 lb x 1.0 lb.....	2.0"	1.5"	0.875"	0.5"	1.0"	10.0"
69672.....	3200 lb x 1.0 lb.....	2.0"	1.5"	0.875"	0.5"	1.0"	10.0"
69673.....	5000 lb x 2.0 lb.....	2.625"	2.0"	1.125"	0.75"	1.125"	11.5"
69674.....	6000 lb x 2.0 lb.....	2.625"	2.0"	1.125"	0.75"	1.125"	11.5"
69675.....	6400 lb x 2.0 lb.....	2.625"	2.0"	1.125"	0.75"	1.125"	11.5"
Six-digit, 1.6" (40mm) Indicator Display							
69669.....	1000 lb x 0.5 lb.....	2.0"	1.5"	0.875"	0.5"	1.0"	10.0"
69676.....	10,000 lb x 5.0 lb.....	3.5"	2.5"	1.5"	1.0"	1.4375"	13.0"
69677.....	20,000 lb x 10.0 lb.....	4.0"	3.125"	2.25"	1.25"	2.25"	19.0"

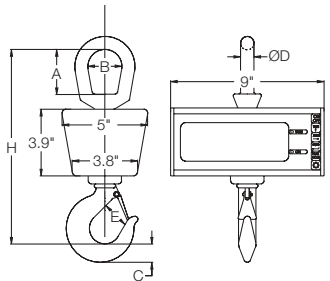

RON 3000 SINGLE & DUAL DISPLAY

SINGLE PART #	DUAL PART #	CAPACITY	A	B	C	D Ø	E	H
Four-digit, 2.0" (50mm) Indicator Display								
68552.....	68343.....	500 lb x 0.2 lb.....	2.0"	1.5"	0.875"	0.5"	1.0"	10.0"
68554.....	68345.....	2000 lb x 1.0 lb.....	1.5"	1.25"	0.75"	0.375"	0.875"	9.0"
68555.....	68346.....	2500 lb x 1.0 lb.....	2.0"	1.5"	0.875"	0.5"	1.0"	10.0"
68556.....	68347.....	3200 lb x 1.0 lb.....	2.0"	1.5"	0.875"	0.5"	1.0"	10.0"
68557.....	68348.....	5000 lb x 2.0 lb.....	2.625"	2.0"	1.125"	0.75"	1.125"	11.5"
68558.....	68349.....	6000 lb x 2.0 lb.....	2.625"	2.0"	1.125"	0.75"	1.125"	11.5"
68559.....	68350.....	6400 lb x 2.0 lb.....	2.625"	2.0"	1.125"	0.75"	1.125"	11.5"
Six-digit, 1.6" (40mm) Indicator Display								
68553.....	68344.....	1000 lb x 0.5 lb.....	2.0"	1.5"	0.875"	0.5"	1.0"	10.0"
68560.....	68351.....	10,000 lb x 5.0 lb.....	3.5"	2.5"	1.5"	1.0"	1.4375"	13.0"
68561.....	68352.....	20,000 lb x 10.0 lb.....	4.0"	3.125"	2.25"	1.25"	2.25"	19.0"

